

Flat Roof

1. DPC
2. Wallplate
3. Slate Cavity Closer
4. Soffit Board
5. Fascia Board
6. Gutter
7. 25 x 50 Batten
8. 150 x 44 Ceiling Joist
9. Furring Piece (1:40)
10. 18mm Plywood Decking
11. Vapour Control Layer
12. 100mm Rigid Insulation
13. Weatherproofing (3 layers of felt)
14. Tilting Fillet
15. Lead Flashing
16. Stepped DPC

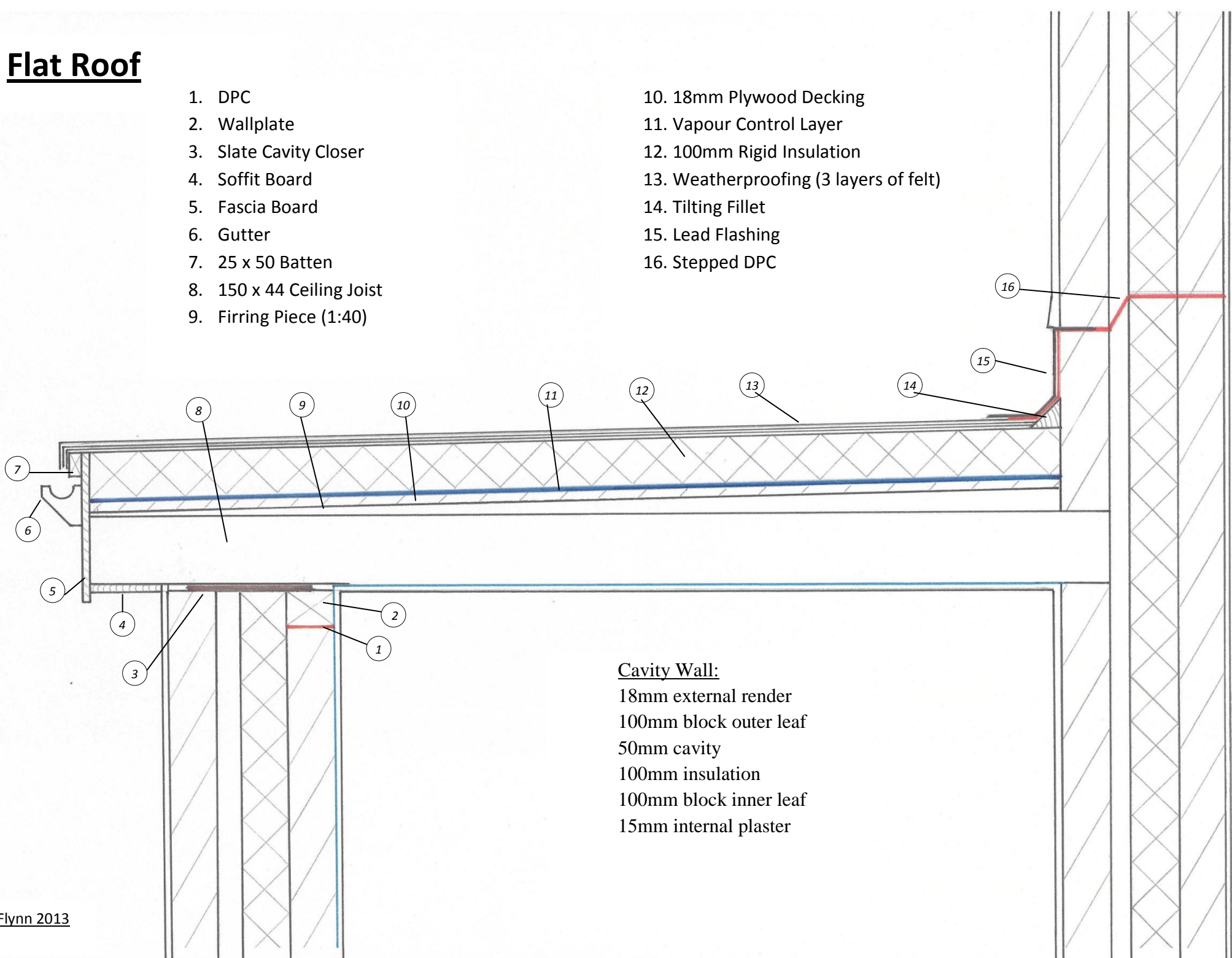

Cavity Wall:

- 18mm external render
- 100mm block outer leaf
- 50mm cavity
- 100mm insulation
- 100mm block inner leaf
- 15mm internal plaster